

Route between: ● ED - Emergency Department (Zone A - Upper Floor —)
 ■ C40 - Pharmacy Dispensary (Zone C - Lower Floor —)

Alternative Shorter Route (when available —)

Location of: ▲ A14 - Radiology/Xray
 ◆ C30 - Restaurant

EMERGENCY DEPARTMENT (A&E)

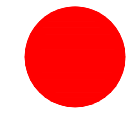

You are here

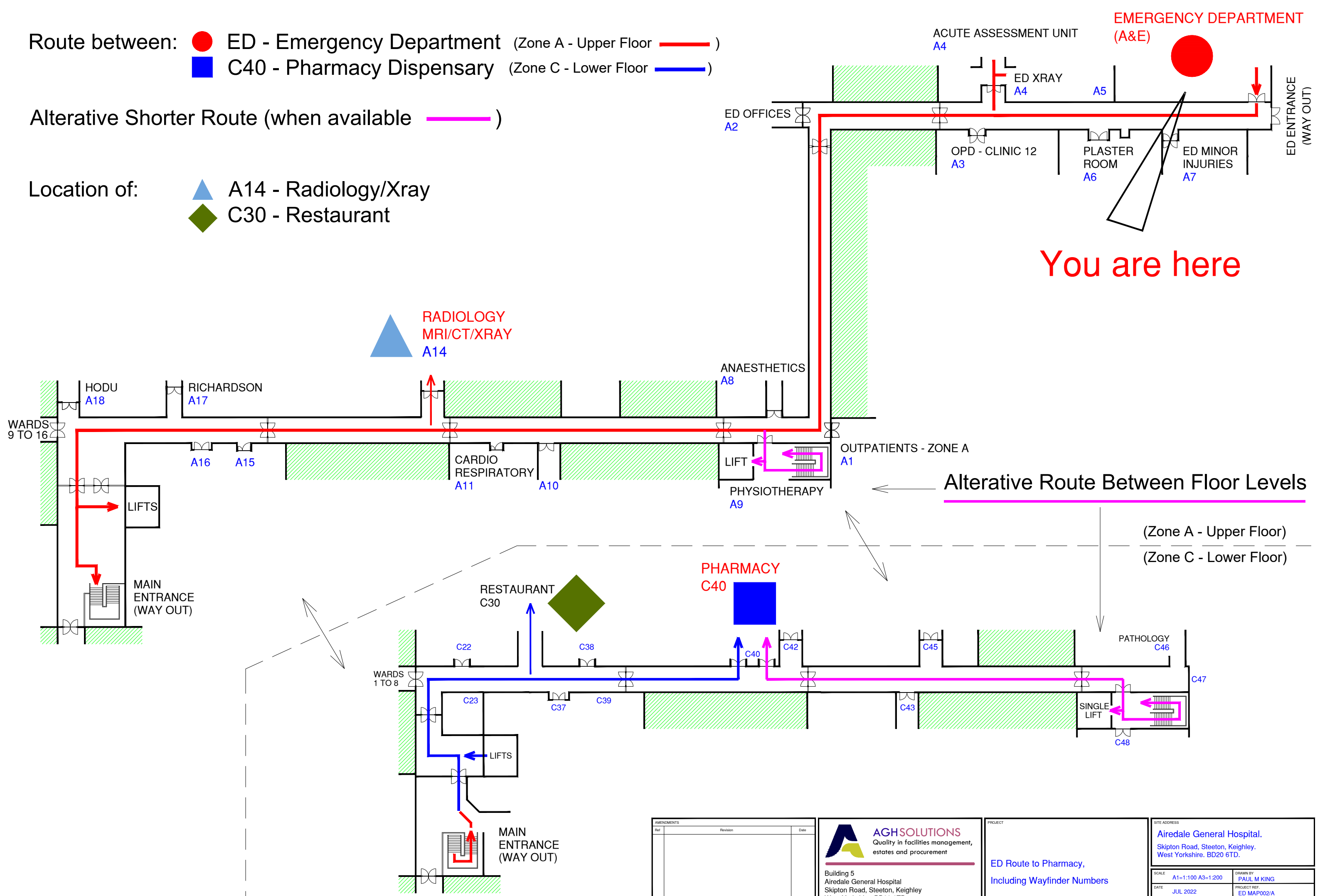

Ref	Revision	Date

GENERAL NOTES
 Do not scale off this drawing.
 All dimensions MUST be checked on site prior to commencement of any works.
 Copyright of Airedale NHS Trust, 2018.

AGHSOLUTIONS
 Quality in facilities management, estates and procurement

Building 5
 Airedale General Hospital
 Skipton Road, Steeton, Keighley
 West Yorkshire, BD20 6TD

TELEPHONE: (01535) 294821
 EMAIL: paul.king@anhsL.nhs.uk

PROJECT
 ED Route to Pharmacy,
 Including Wayfinder Numbers

SITE ADDRESS
 Airedale General Hospital,
 Skipton Road, Steeton, Keighley,
 West Yorkshire, BD20 6TD.

SCALE: A1=1:100 A3=1:200
 DATE: JUL 2022
 DRAWN BY: PAUL M KING
 PROJECT REF: ED MAP002/A

DRAWING No. **ROUTE - MAP ED 002**